

**parter 33,11m<sup>2</sup>**

- 1 wiatrołap: 2,24 m<sup>2</sup>
- 2 kuchnia+pokój dzienny: 25,00 m<sup>2</sup>
- 3 schody: 4,11 m<sup>2</sup>
- 4 wc: 1,76 m<sup>2</sup>

**piętro 36,23m<sup>2</sup>**

- 5 hol+schody: 9,47 m<sup>2</sup>
- 6 sypialnia: 9,84 m<sup>2</sup>
- 7 łazienka: 5,68 m<sup>2</sup>
- 8 sypialnia: 11,24 m<sup>2</sup>

**strych 31,67m<sup>2</sup>**

- 9 hol: 5,22 m<sup>2</sup>
- 10 strych: 26,45 m<sup>2</sup>  
pow. po obrysie podłogi

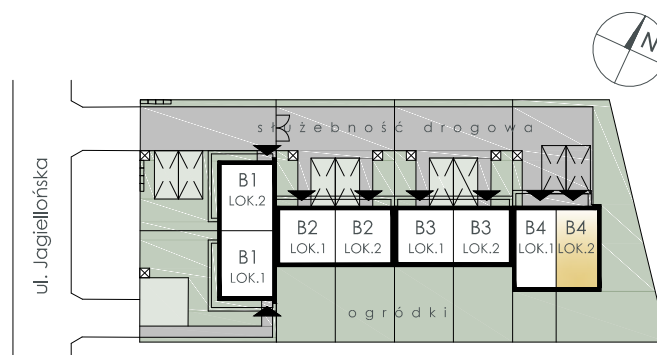
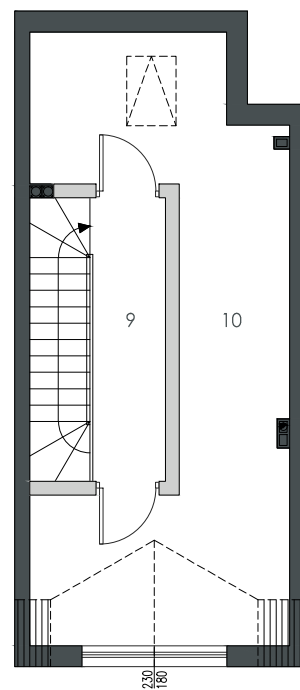
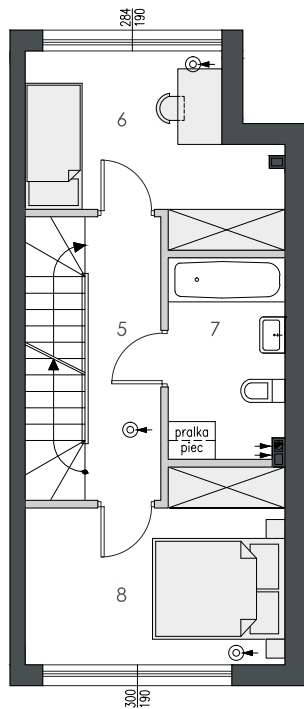
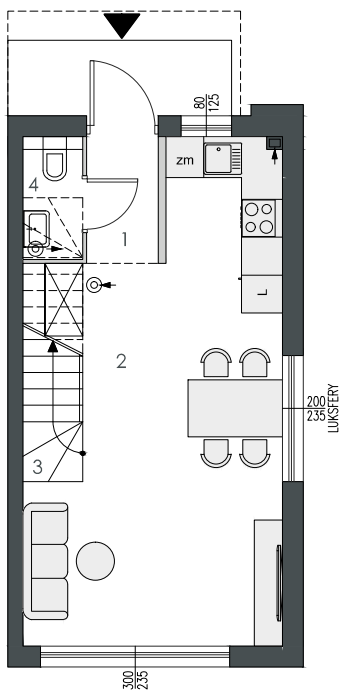

■ Ściany konstrukcyjne : nierozbieralne

■ Ściany działowe

